



Sweetwater Environmental Management, LLC

720 East Landis Avenue, Rear
Vineland, New Jersey 08360

School Potable Water System Lead Testing

**Caroline L. Reutter School
2150 Delsea Drive
Franklinville, NJ 08322**

06/29/2022

Prepared By:
Frederick J. Gross, REM • CEA • LO
Sweetwater Environmental Management, LLC

Drinking Water Outlet Inventory & Results

Name of School: Caroline L. Reutter School_ Address: 2150 Delsea Drive, Franklinville, NJ 08322

Date Completed: 5/24/2022

#	Outlet Type	Location	Code	Lead Result ug/l *	Lead Limit ug/l *	Map ID	Comments
1	Water Cooler	East West Hall	CRS-EWHL-WC-01	N/A	N/A	01	Out-Of-Service, No Sample
2	Sink	Room 33	CRS-RM33-TL-02	<1	15	02	SAMPLE, In compliance
3	Sink	Staff Restroom	CRS-STBR-BS-02.1	N/A	N/A	02.1	Non-Drinking Water Outlet, No Sample
4	Sink	Staff Restroom	CRS-STBR-BS-02.2	N/A	N/A	02.2	Non-Drinking Water Outlet, No Sample
5	Sink	Room 19	CRS-RM19-AS-03	N/A	N/A	03	Non-Drinking Water Outlet, No Sample
6	Sink	Room 19	CRS-RM19-AS-04	N/A	N/A	04	Non-Drinking Water Outlet, No Sample
7	Sink	Room 19	CRS-RM19-AS-05	N/A	N/A	05	Non-Drinking Water Outlet, No Sample
8	Sink	South West Girl's Room	CRS-SWHG-BS-06	N/A	N/A	06	Non-Drinking Water Outlet, No Sample
9	Sink	South West Girl's Room	CRS-SWHG-BS-07	N/A	N/A	07	Non-Drinking Water Outlet, No Sample
10	Sink	South West Girl's Room	CRS-SWHG-BS-08	N/A	N/A	08	Non-Drinking Water Outlet, No Sample
11	Bubbler	South West Hall	CRS-SWHL-DW-09	N/A	N/A	09	Out-Of-Service, No Sample
12	Sink	South West Boy's Room	CRS-SWHB-BS-10	N/A	N/A	10	Non-Drinking Water Outlet, No Sample
13	Sink	South West Boy's Room	CRS-SWHB-BS-11	N/A	N/A	11	Non-Drinking Water Outlet, No Sample
14	Sink	South West Boy's Room	CRS-SWHB-BS-12	N/A	N/A	12	Non-Drinking Water Outlet, No Sample
15	Bubbler	South West Hall	CRS-SWHL-DW-13	N/A	N/A	13	Out-Of-Service, No Sample
16	Sink	Room 32	CRS-RM32-BS-14	N/A	N/A	14	Non-Drinking Water Outlet, No Sample

* ug/l = Micrograms per Liter or Parts per Billion

TABLE KEY

	Sample collected, the result was less than the LEAD Action Limit (15 ug/l), sample is acceptable for potable water.
	Sample collected, the result was greater than the LEAD Action Limit (15 ug/l), outlet was removed and plumbing sealed.
	N/A NO Sample collected, outlet exempted, NOT A DRINKING WATER SOURCE, sanitation only hand wash or equipment sink

#	Outlet Type	Location	Code	Lead Result ug/l *	Lead Limit ug/l *	Map ID	Comments
17	Sink	Room 30	CRS-RM30-BS-15	N/A	N/A	15	Non-Drinking Water Outlet, No Sample
18	Bubbler	North Hall	CRS-NHL-DW-16	N/A	N/A	16	Out-Of-Service, No Sample
19	Sink	Room 38	CRS-RM38-NS-17	<1	15	17	SAMPLE, In compliance
20	Sink	Kitchen Prep Sink	CRS-KIT1-KC-18	<1	15	18	SAMPLE, In compliance
21	Sink	Kitchen Dish Sink	CRS-KIT1-DS-19	N/A	N/A	19	Outlet, Permanently Removed
22	Sink	Kitchen Dish Sink	CRS-KIT1-DS-19.1	N/A	N/A	9.1	Outlet, Permanently Removed
23	Sink	Kitchen Prep Sink	CRS-KIT2-KC-20	2.4	15	20	SAMPLE, In compliance
24	Sink	Kitchen Dish Sink	CRS-KIT2-DS-21	5.8	15	21	SAMPLE, In compliance
25	Sink	Kitchen Hand Sink	CRS-KIT3-HS-22	<1	15	22	SAMPLE, In compliance
26	Bubbler	East West Hall	CRS-EWHL-DW-23	N/A	N/A	23	Permanently, Out Of Service
27	Bottle filling	East West Hall	CRS-EWHL-DW-24	<1	15	24R	SAMPLE, In compliance
28	Sink	South East Boy's Room	CRS-SEHB-BS-25	N/A	N/A	24	Non-Drinking Water Outlet, No Sample
29	Sink	South East Boy's Room	CRS-SEHB-BS-25.1	N/A	N/A	25.1	Non-Drinking Water Outlet, No Sample
30	Sink	South East Boy's Room	CRS-SEHB-BS-26	N/A	N/A	26	Non-Drinking Water Outlet, No Sample
31	Sink	South East Boy's Room	CRS-SEHB-BS-26.1	N/A	N/A	26.1	Non-Drinking Water Outlet, No Sample
32	Water Cooler	South East Hall	CRS-SEHL-WC-27	N/A	N/A	27	Out-Of-Service, No Sample
33	Water Cooler	South East Hall	CRS-SEHL-WC-28	N/A	N/A	28	Out-Of-Service, No Sample
34	Sink	South East Girl's Room	CRS-SEHG-BS-29	N/A	N/A	29	Non-Drinking Water Outlet, No Sample
35	Sink	South East Girl's Room	CRS-SEHG-BS-30	N/A	N/A	30	Non-Drinking Water Outlet, No Sample
36	Bubbler	South East Hall	CRS-SEHL-DW-31	N/A	N/A	31	Permanently, Out Of Service
37	Sink	Room 41 Library Office	CRS-RM41-KC-32	N/A	15	32	Outlet, Permanently Removed

* ug/l = Micrograms per Liter or Parts per Billion

TABLE KEY

	Sample collected, the result was less than the LEAD Action Limit (15 ug/l), sample is acceptable for potable water.
	Sample collected, the result was greater than the LEAD Action Limit (15 ug/l), outlet was removed and plumbing sealed.
	N/A NO Sample collected, outlet exempted, NOT A DRINKING WATER SOURCE, sanitation only hand wash or equipment sink

#	Outlet Type	Location	Code	Lead Result ug/l *	Lead Limit ug/l *	Map ID	Comments
38	Sink	Room 41	CRS-RM41-HS-33	N/A	N/A	33	Non-Drinking Water Outlet, No Sample
39	Water Cooler	North Hall	CRS-NHL-WC-34	N/A	N/A	34	Out-Of-Service, No Sample
40	Bubbler	North Hall	CRS-NHL-DW-35	N/A	N/A	35	Out-Of-Service, No Sample
41	Sink	North East Boy's Room	CRS-NEHB-BS-36	N/A	N/A	36	Non-Drinking Water Outlet, No Sample
42	Sink	North East Boy's Room	CRS-NEHB-BS-36.1	N/A	N/A	36.1	Non-Drinking Water Outlet, No Sample
43	Sink	North East Boy's Room	CRS-NEHB-BS-37	N/A	N/A	37	Non-Drinking Water Outlet, No Sample
44	Bubbler	North East Hall	CRS-NEHL-DW-38	N/A	N/A	38	Out-Of-Service, No Sample
45	Sink	North East Girl's Room	CRS-NEHG-BS-39	N/A	N/A	39	Non-Drinking Water Outlet, No Sample
46	Sink	North East Girl's Room	CRS-NEHG-BS-39.1	N/A	N/A	39.1	Non-Drinking Water Outlet, No Sample
47	Sink	North East Girl's Room	CRS-NEHG-BS-40	N/A	N/A	40	Non-Drinking Water Outlet, No Sample

* ug/l = Micrograms per Liter or Parts per Billion

TABLE KEY

	Sample collected, the result was less than the LEAD Action Limit (15 ug/l), sample is acceptable for potable water.
	Sample collected, the result was greater than the LEAD Action Limit (15 ug/l), outlet was removed and plumbing sealed.
	N/A NO Sample collected, outlet exempted, NOT A DRINKING WATER SOURCE, sanitation only hand wash or equipment sink

- 1952 CONSTRUCTION
- 1958 ADDITION
- 2007 ADDITION
- 2012 REMODELED

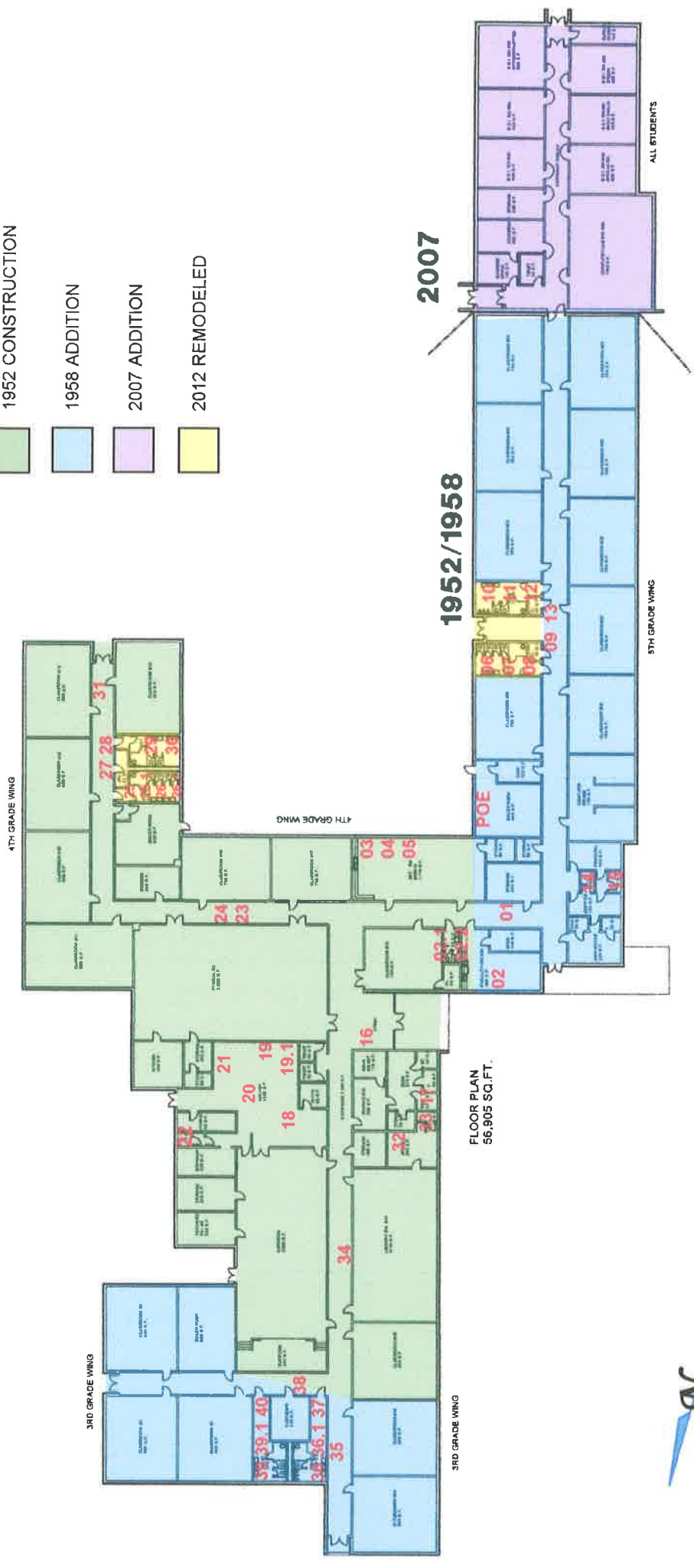

FLOOR PLAN
56,905 SQ.FT.

<h2>Potable Water Inventory / Lead Sampling Map</h2> <h3>Caroline L. Reutter School</h3> <p>2150 Delsea Drive Franklinville, NJ 08322</p>		<p>PREPARED FOR: Franklin Township Board of Education</p>	<p>FIGURE 1</p>
DRAWN BY FJG	FILE FBE	DATE 06/30/2017	SCALE NTS
<p>SWEETWATER ENVIRONMENTAL MANAGEMENT, LLC</p> <p>720 East Landis Avenue, Rear Vineland, NJ 08360 Phone: (856) 205-1999 Fax: (856) 205-1825</p>			